

order number	lens name
0701-399-000-42	Rodagon-WA 4/40 full metal

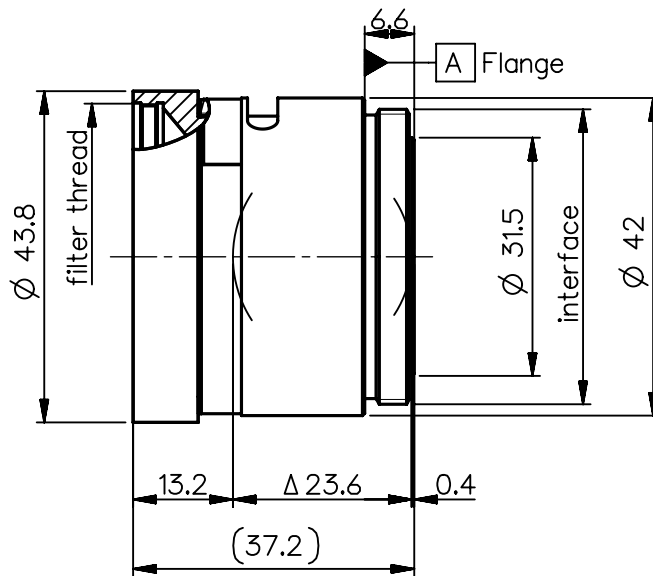

Specification		ON	7411-9001
image circle max. (mm)	46	working distance (mm)	175-625
focal length f' (mm)	40.4	interface	M39x1/26" (Leica)
magnification β' [range]	-0.1 [-0.25 ... -0.066]	filter thread	M40.5x0.5
spectral range λ (nm)	400-750	weight (g)	95

schematic diagram		*) in air		design includes CCD cover glass: no							
				SF (mm)	-26.5	f-stop	4	Ø EnP	5.0	Ø Exp	10.7
				S'F' (mm) *)	31.2						
				HH' (mm) *)	0.5						
				SH (mm)	13.9						
				S'H' (mm) *)	-9.2						
				SEnP (mm)	11.1						
				S'Exp (mm) *)	-12.2						

NX	EU-D		AL-T1A		US-D		US-ML		not export controlled		
							PDM Status Freigabe		-		
PROTECTIVE NOTE "DIN ISO 16016" TO BE OBSERVED	REV	ECC	DATE	APPROVED	GENERAL TOLERANCE OF DIMENSION, FORM, POS.	SURF. TREATMT	SCALE 1:1				
	b	16-0380	16.06.16	Bo11			MATERIAL				
	BASIC TOLERANCING PRINCIPLE						TITLE				
							Rodagon-WA 4/40 full metal				
DIN A 4					FIRST	DATE	NAME	DRAWING NO.			SHEET 1 OF 1
					ISSUE	16.06.16	Bo11	0701-399-100-42-0001b			
ALL DIMENSIONS ARE IN MM AND INCLUDE SURFACE TREATMENT						CHKD 16.06.16 Stauder		REPLACES			



# Rodagon-WA\_4/40

MTF at ratio -0.1 f/ 4.0

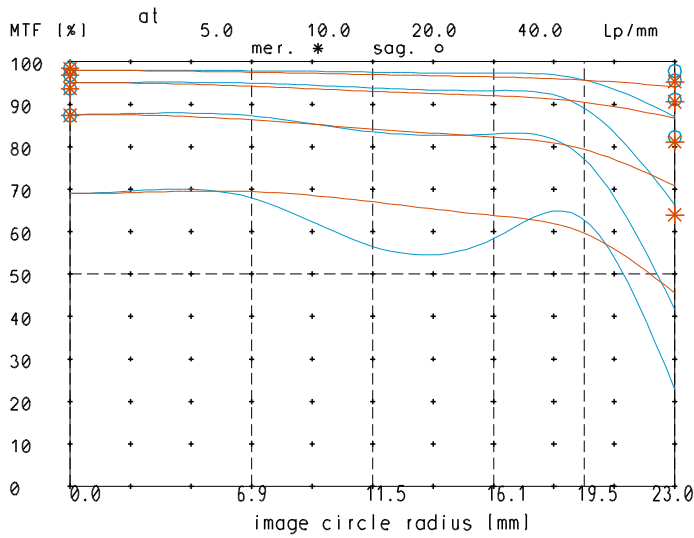

relative light fall-off at ratio -0.1

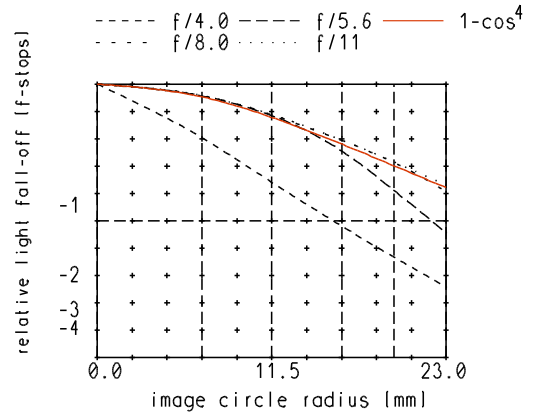

MTF at ratio -0.1 f/ 8.0

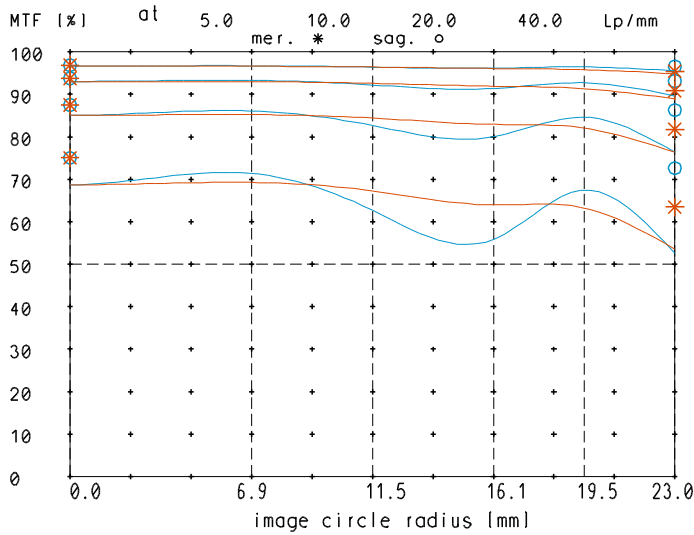

Distortion at ratio 0.05x to 0.5x

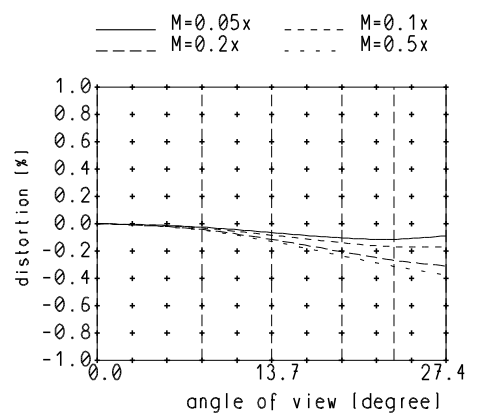

— sagittal. o Diffraction limited value  
— meridional \* Diffraction limited value

Longitudinal color aberration at ratio -0.1

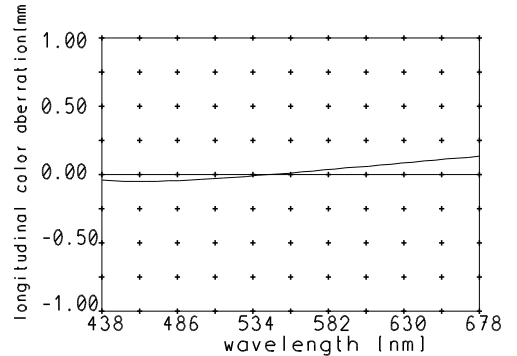

Named frequencies (line pairs/mm) in modular transfer function (MTF) as well as diagrams of relative light fall-off, distortion and longitudinal color aberration refer to film plane.